

Hiroo Heights Apartment No. 802 (8F)

Update Date : 2025/1/18 Next scheduled update date: Anytime

| | | | |
|----------------------------|---|---|---------------------------------------|
| Layout(Type) | 1LDK(A3) | Area | 64.80㎡ (697.248 sq. ft.) |
| Rent | ¥ 334,000 | Public maintenance fee Administration cost | ¥ 15,000 |
| Deposit Key money | 2 Months · None | Renewal fee | None |
| Transaction type (Year) | Periodic Tenancy Contract (3 Years) | Status | Vacancy soon (Moving out: 02/2025) |
| Note | Auto-lock Pet is negotiable A/C installed Instrument is negotiable 1 month rent will be deducted at the time of move-out. *This property is only for residential purposes, except the SOHO | | |
| Equipments | Please contact us if there is any question. | | |
| Completed | September, 2002 | | |
| Constructing | · Reinforced concrete · 12 stories | | |
| Location | 2-38-12 Ebisu, Shibuya-ku, Tokyo | | |
| Trains | Hiroo Stn., Hibiya Line (10-min. walk) Ebisu Stn., JR Line (14-min. walk) | | |

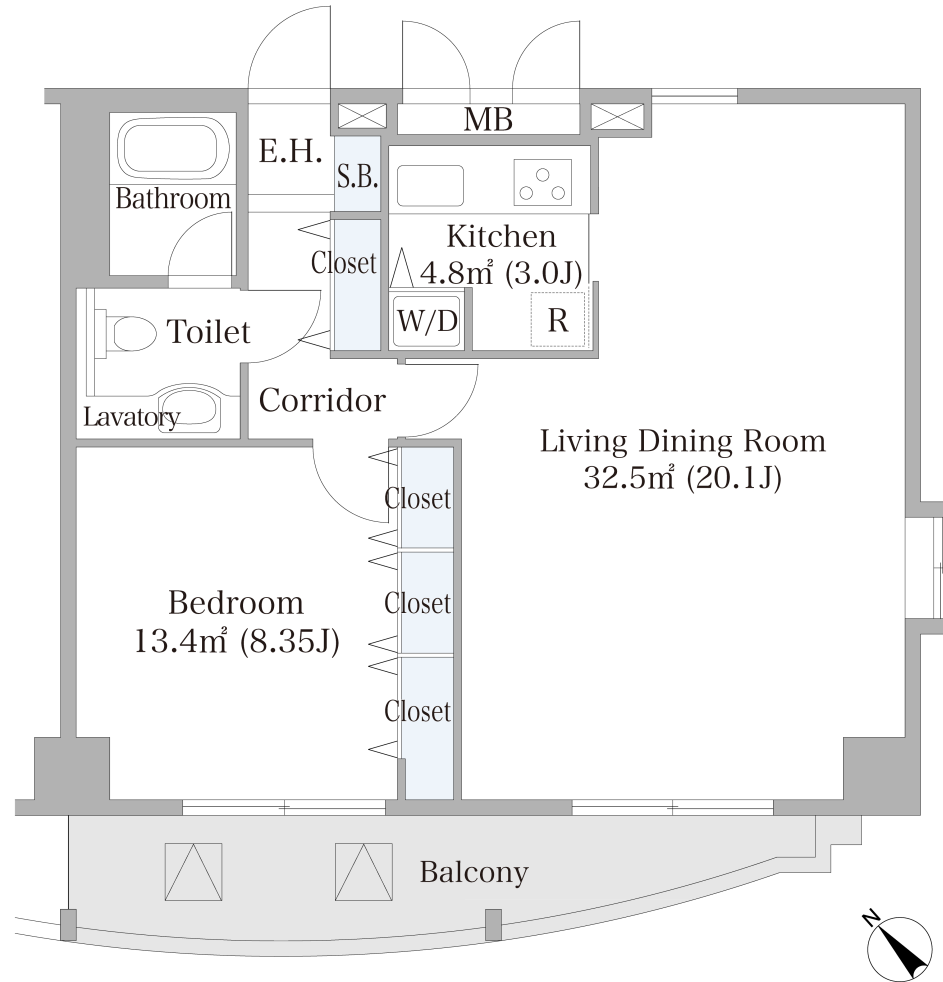

- 1 Lease guarantee agreement: required (by a guarantee company designated by us)
 Guarantee fee: 30% of lease for the first year, 8,000 yen/year for the second and subsequent years
 Fees may vary depending on the guarantee company - contact us for more details.
- 2 All rentals are on a first-come-first-served basis.
- 3 Multi-risk home insurance is mandatory.
- 4 Deposits equivalent to one month of rent are non-refundable at the end of the contract.
- 5 If the contract is terminated in less than one year, a penalty equivalent to one-month rent will be applied.
- 6 When disparities arise between the drawing and the actual construction, the actual construction takes precedence.

Sumitomo Realty & Development Co., Ltd.

Shinjuku NS Building, 2-4-1, Nishi-Shinjuku Shinjuku-ku, Tokyo 163-0820 Japan

Phone: +81-3-3346-9510

Phone: 0120-770-507

for Real estate company: +81-3-3346-9510

Please contact us if there is any question.