

# Kachidoki Heights Apartment No. 806 (8F)

Update Date : 2024/11/23 Next scheduled update date: Anytime

Layout(Type)	1LDK(B1)	Area	48.85㎡ (525.626 sq. ft.)
Rent	¥ 199,000	Public maintenance fee Administration cost	¥ 15,000
Deposit Key money	2 Months · None	Renewal fee	None
Transaction type (Year)	Periodic Tenancy Contract (3 Years)	Status	Vacancy soon (Moving out: 01/2025)
Note	<p>•This property is only for residential purposes, except the SOHO</p>		
Equipments	Please contact us if there is any question.		
Completed	July,2002		
Constructing	· Steel frame reinforced concrete · 8 Stories		
Location	3-9-7 Kachidoki ,Chuo-ku ,Tokyo		
Trains	Kachidoki Stn., Oedo Line (5-min walk)		
			

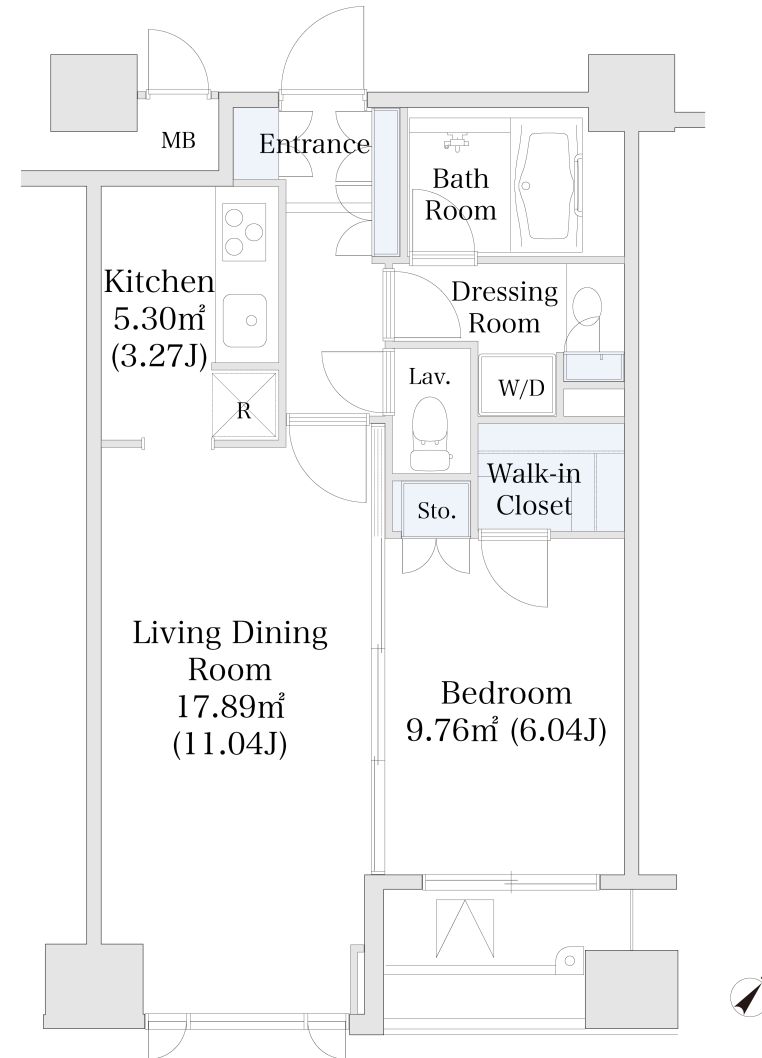

- 1 Lease guarantee agreement: required (by a guarantee company designated by us)  
Guarantee fee: 30% of lease for the first year, 8,000 yen/year for the second and subsequent years  
Fees may vary depending on the guarantee company - contact us for more details.
- 2 All rentals are on a first-come-first-served basis.
- 3 Multi-risk home insurance is mandatory.
- 4 Deposits equivalent to one month of rent are non-refundable at the end of the contract.
- 5 If the contract is terminated in less than one year, a penalty equivalent to one-month rent will be applied.
- 6 When disparities arise between the drawing and the actual construction, the actual construction takes precedence.

Sumitomo Realty & Development Co., Ltd.

Shinjuku NS Building, 2-4-1, Nishi-Shinjuku Shinjuku-ku, Tokyo 163-0820 Japan

Phone: +81-3-3346-9510

Phone: 0120-770-507

for Real estate company: +81-3-3346-9510

Please contact us if there is any question.