

# La Tour Shibakoen II Apartment No. 2703 (27F)

Update Date : 2025/1/19 Next scheduled update date: Anytime

Layout(Type)	3LDK(E')	Area	198.52m <sup>2</sup> (2136.0752 sq. ft.)
Rent	¥ 1,561,000	Public maintenance fee Administration cost	included in rent
Deposit Key money	2 Months • None	Renewal fee	None
Transaction type (Year)	Periodic Tenancy Contract (3 Years)	Status	Move-in date negotiable (Being restored)
Note	<p>Limited term contract (3years) 24hours manned admin. Fitness room is available Pet is negotiable 1 month rent will be deducted at the time of move-out.</p> <p>•This property is only for residential purposes, except the SOHO</p>		
Equipments	Please contact us if there is any question.		
Completed	July,2001		
Constructing	• Steel-frame, reinforced concrete • Dual anti-earth quake system • 30 stories		
Location	2-11-1 Shiba-Koen, Minato-ku, Tokyo		
Trains	Shibakoen Stn., Mita Line (3-min. walk ) Daimon Stn., Asakusa/Oedo Lines (7-min. walk) Hamamatsu Stn., Tokyo Monorail/JR Line (8-min. walk)		

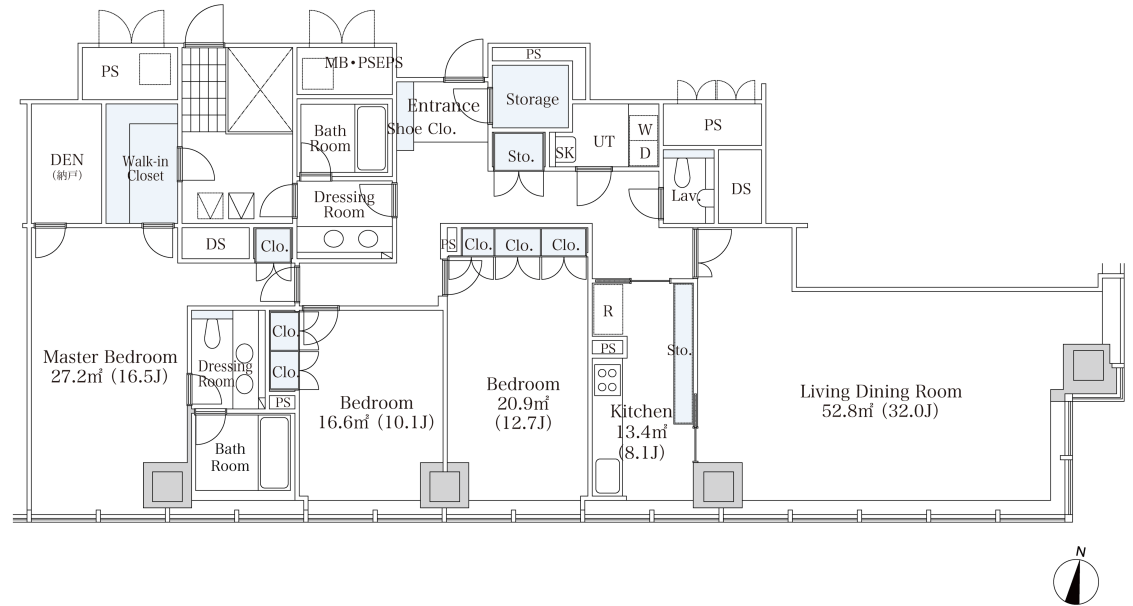

- 1 Lease guarantee agreement: required (by a guarantee company designated by us)  
Guarantee fee: 30% of lease for the first year, 8,000 yen/year for the second and subsequent years  
Fees may vary depending on the guarantee company - contact us for more details.
- 2 All rentals are on a first-come-first-served basis.
- 3 Multi-risk home insurance is mandatory.
- 4 Deposits equivalent to one month of rent are non-refundable at the end of the contract.
- 5 If the contract is terminated in less than one year, a penalty equivalent to one-month rent will be applied.
- 6 When disparities arise between the drawing and the actual construction, the actual construction takes precedence.

Sumitomo Realty & Development Co., Ltd.

Shinjuku NS Building, 2-4-1, Nishi-Shinjuku Shinjuku-ku, Tokyo 163-0820 Japan

Phone: +81-3-3346-9510

Phone: 0120-770-507

for Real estate company: +81-3-3346-9510

Please contact us if there is any question.