

# Izumi Garden Residence

# Apartment No. 2008 (20F)

Update Date : 2024/10/9 Next scheduled update date: Anytime

Layout(Type)	3LDK(G1)	Area	119.47m <sup>2</sup> (1285.4972 sq. ft.)
Rent	¥ 1,050,000	Public maintenance fee Administration cost	included in rent
Deposit Key money	2 Months · None	Renewal fee	None
Transaction type (Year)	Periodic Tenancy Contract (3 Years)	Status	Vacancy soon (Moving out: 11/2024)
Note	Limited term contract (3 years) Advanced security system Fitness club is available Pet is negotiable 1 month rent will be deducted at the time of move-out.  •This property is only for residential purposes, except the SOHO		
Equipments	Please contact us if there is any question.		
Completed	September, 2002		
Constructing	· Steel-frame, reinforced concrete · Vibration-contr ol of construction · 32 stories		
Location	1-5-3 Roppongi-Itchome, Minato-ku, Tokyo		
Trains	Roppongi-Itchome Stn., Namboku Lin e (2-min. walk) Kamiyacho Stn., Hibiya Line (8-min. w alk)		

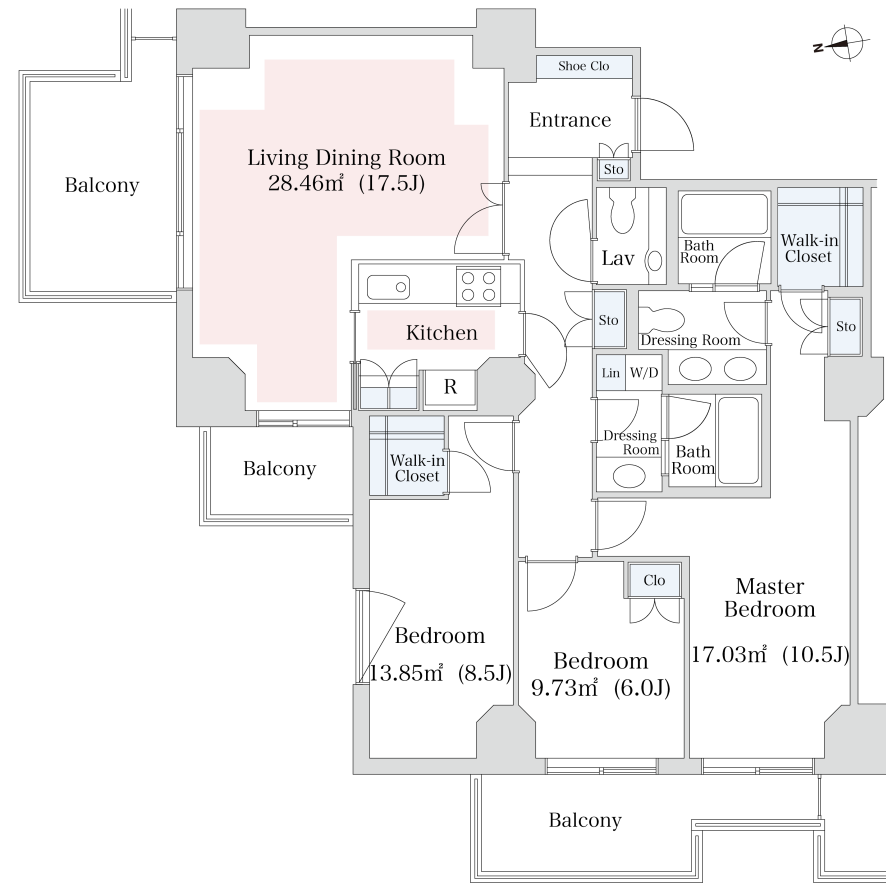

- 1 Lease guarantee agreement: required (by a guarantee company designated by us)  
 Guarantee fee: 30% of lease for the first year, 8,000 yen/year for the second and subsequent years  
 Fees may vary depending on the guarantee company - contact us for more details.
- 2 All rentals are on a first-come-first-served basis.
- 3 Multi-risk home insurance is mandatory.
- 4 Deposits equivalent to one month of rent are non-refundable at the end of the contract.
- 5 If the contract is terminated in less than one year, a penalty equivalent to one-month rent will be applied.
- 6 When disparities arise between the drawing and the actual construction, the actual construction takes precedence.

Sumitomo Realty & Development Co., Ltd.

Shinjuku NS Building, 2-4-1, Nishi-Shinjuku Shinjuku-ku, Tokyo 163-0820 Japan

Phone: +81-3-3346-9510

Phone: 0120-770-507

for Real estate company: +81-3-3346-9510

Please contact us if there is any question.