

# La Tour Hanzomon Apartment No. 1401 (14F)

Update Date : 2025/2/23 Next scheduled update date: Anytime

Layout(Type)	3LDK(A)	Area	160.43㎡ (1726.2268 sq. ft.)
Rent	¥ 1,499,000	Public maintenance fee Administration cost	included in rent
Deposit Key money	2 Months · None	Renewal fee	None
Transaction type (Year)	Periodic Tenancy Contract (3 Years)	Status	Move-in date negotiable (Being restored)
Note	<p>Advanced security system 1 month rent will be deducted at the time of move-out.</p> <p>•This property is only for residential purposes, except the SOHO</p>		
Equipments	Please contact us if there is any question.		
Completed	January,2004		
Constructing	<ul style="list-style-type: none"> <li>Steel-frame, reinforced concrete</li> <li>Seismic isolation structure</li> <li>15 stories</li> </ul>		
Location	1-4 Kojimachi, Chiyoda-ku, Tokyo		
Trains	<p>Hanzomon Stn., Hanzomon Line (3-min. walk)</p> <p>Kojimachi Stn., Yurakucho Line (8-min. walk)</p>		

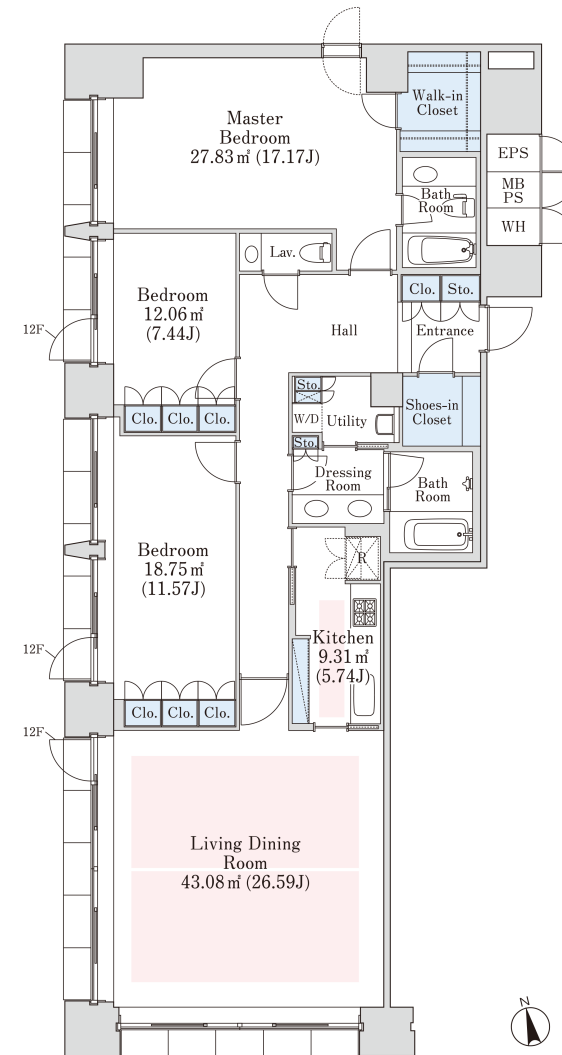

- Lease guarantee agreement: required (by a guarantee company designated by us)  
Guarantee fee: 30% of lease for the first year, 8,000 yen/year for the second and subsequent years  
Fees may vary depending on the guarantee company - contact us for more details.
- All rentals are on a first-come-first-served basis.
- Multi-risk home insurance is mandatory.
- Deposits equivalent to one month of rent are non-refundable at the end of the contract.
- If the contract is terminated in less than one year, a penalty equivalent to one-month rent will be applied.
- When disparities arise between the drawing and the actual construction, the actual construction takes precedence.

Sumitomo Realty & Development Co., Ltd.

Shinjuku NS Building, 2-4-1, Nishi-Shinjuku Shinjuku-ku, Tokyo 163-0820 Japan

Phone: +81-3-3346-9510

Phone: 0120-770-507

for Real estate company: +81-3-3346-9510

Please contact us if there is any question.