

# La Tour Mita Apartment No. 3209 (32F)

Update Date : 2025/1/19 Next scheduled update date: Anytime

|                            |                                                                                                                                                                                                                   |                                               |                                       |
|----------------------------|-------------------------------------------------------------------------------------------------------------------------------------------------------------------------------------------------------------------|-----------------------------------------------|---------------------------------------|
| Layout(Type)               | 1LDK(M)                                                                                                                                                                                                           | Area                                          | 77.03㎡ (828.8428 sq. ft.)             |
| Rent                       | ¥ 600,000                                                                                                                                                                                                         | Public maintenance fee<br>Administration cost | included in rent                      |
| Deposit<br>Key money       | 2 Months · None                                                                                                                                                                                                   | Renewal fee                                   | None                                  |
| Transaction type<br>(Year) | Periodic Tenancy Contract<br>(3 Years)                                                                                                                                                                            | Status                                        | Vacancy soon<br>(Moving out: 01/2025) |
| Note                       | Limited term contract (3years)<br>Advanced security system<br>Pet is negotiable<br>1 month rent will be deducted at the time of move-out.<br><br>•This property is only for residential purposes, except the SOHO |                                               |                                       |
| Equipments                 | Please contact us if there is any question.                                                                                                                                                                       |                                               |                                       |
| Completed                  | September, 2006                                                                                                                                                                                                   |                                               |                                       |
| Constructing               | · Steel-frame, partially reinforced concrete · Vibrati<br>on-control construction · 43 stories                                                                                                                    |                                               |                                       |
| Location                   | 3-5-27 Mita, Minato-ku, Tokyo                                                                                                                                                                                     |                                               |                                       |
| Trains                     | Mita Stn., Asakusa/Mita Lines (8-min.<br>walk)<br>Sengakuji Stn., Asakusa Line (6-min. w<br>alk)<br>Tamachi Stn., JR Line (9-min. walk)                                                                           |                                               |                                       |

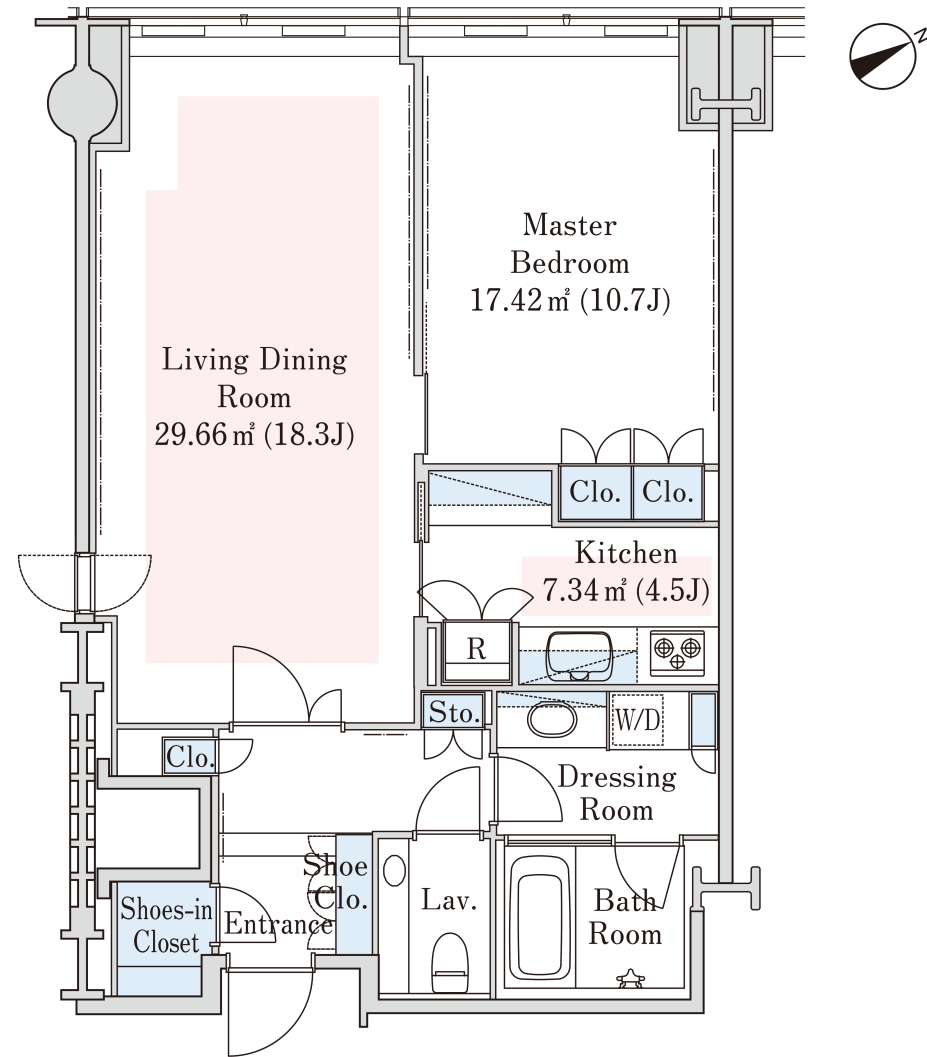

- Lease guarantee agreement: required (by a guarantee company designated by us)  
 Guarantee fee: 30% of lease for the first year, 8,000 yen/year for the second and subsequent years  
 Fees may vary depending on the guarantee company - contact us for more details.
- All rentals are on a first-come-first-served basis.
- Multi-risk home insurance is mandatory.
- Deposits equivalent to one month of rent are non-refundable at the end of the contract.
- If the contract is terminated in less than one year, a penalty equivalent to one-month rent will be applied.
- When disparities arise between the drawing and the actual construction, the actual construction takes precedence.

Sumitomo Realty & Development Co., Ltd.

Shinjuku NS Building, 2-4-1, Nishi-Shinjuku Shinjuku-ku, Tokyo 163-0820 Japan

Phone: +81-3-3346-9510

Phone: 0120-770-507

for Real estate company: +81-3-3346-9510

Please contact us if there is any question.