

# CENTRAL PARK TOWER La Tour Shinjuku Apartment No. 2509 (25F)

Update Date : 2025/2/23 Next scheduled update date: Anytime

|                            |                                                                                                                                                |                                               |                                       |
|----------------------------|------------------------------------------------------------------------------------------------------------------------------------------------|-----------------------------------------------|---------------------------------------|
| Layout(Type)               | 3LDK(B-140W)                                                                                                                                   | Area                                          | 138.91㎡ (1494.6716 sq. ft.)           |
| Rent                       | ¥ 970,000                                                                                                                                      | Public maintenance fee<br>Administration cost | included in rent                      |
| Deposit<br>Key money       | 2 Months · None                                                                                                                                | Renewal fee                                   | None                                  |
| Transaction type<br>(Year) | Periodic Tenancy Contract<br>(3 Years)                                                                                                         | Status                                        | Vacancy soon<br>(Moving out: 03/2025) |
| Note                       | <p>•This property is only for residential purposes, except the SOHO</p>                                                                        |                                               |                                       |
| Equipments                 | Please contact us if there is any question.                                                                                                    |                                               |                                       |
| Completed                  | January,2010                                                                                                                                   |                                               |                                       |
| Constructing               | <p>· Steel construction, steel framed reinforced concrete structure, reinforced concrete construction · 44 stories</p>                         |                                               |                                       |
| Location                   | 6-15-1 Nishi-Shinjuku, Shinjuku-ku, Tokyo                                                                                                      |                                               |                                       |
| Trains                     | <p>Nishi-Shinjuku Stn., Marunouchi Line (7-min. walk)<br/>Tochomae Stn., Oedo Line (5-min. walk)<br/>Shinjuku Stn., JR Line (13-min. walk)</p> |                                               |                                       |
|                            |                                                              |                                               |                                       |

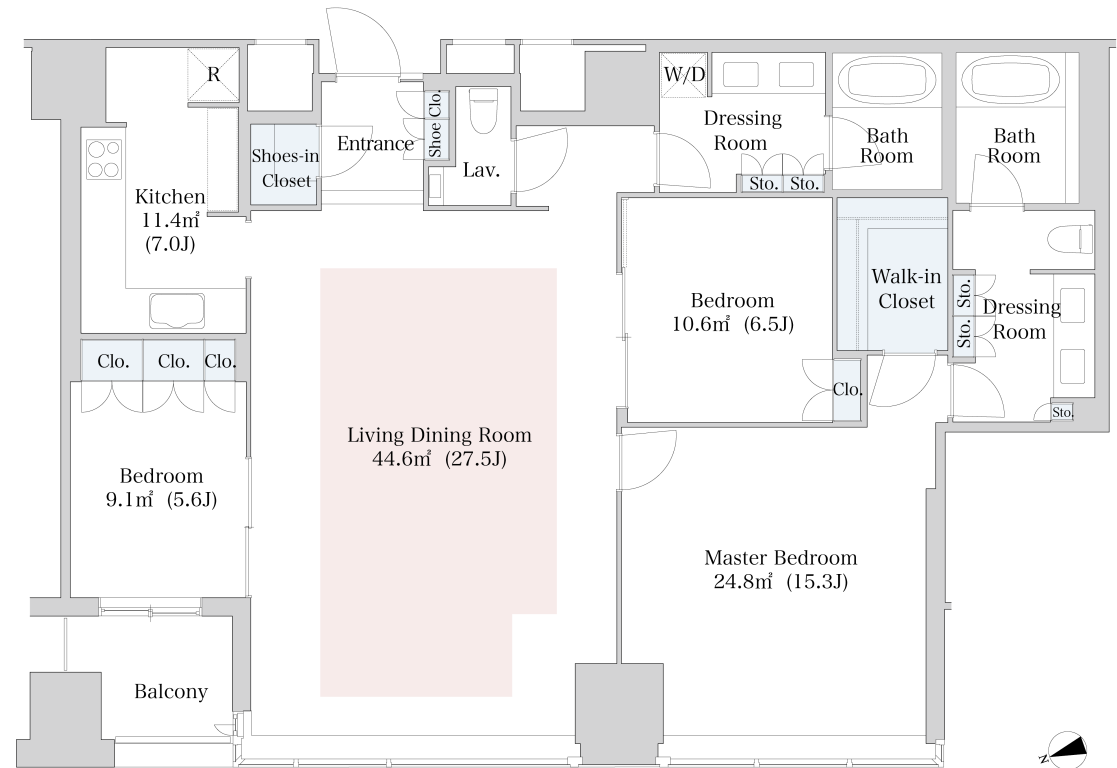

- Lease guarantee agreement: required (by a guarantee company designated by us)  
Guarantee fee: 30% of lease for the first year, 8,000 yen/year for the second and subsequent years  
Fees may vary depending on the guarantee company - contact us for more details.
- All rentals are on a first-come-first-served basis.
- Multi-risk home insurance is mandatory.
- Deposits equivalent to one month of rent are non-refundable at the end of the contract.
- If the contract is terminated in less than one year, a penalty equivalent to one-month rent will be applied.
- When disparities arise between the drawing and the actual construction, the actual construction takes precedence.

Sumitomo Realty & Development Co., Ltd.

Shinjuku NS Building, 2-4-1, Nishi-Shinjuku Shinjuku-ku, Tokyo 163-0820 Japan

Phone: +81-3-3346-9510

Phone: 0120-770-507

for Real estate company: +81-3-3346-9510

Please contact us if there is any question.