

CENTRAL PARK TOWER La Tour Shinjuku Apartment No. 3107 (31F)

Update Date : 2025/1/19 Next scheduled update date: Anytime

| | | | |
|----------------------------|---|---|---------------------------------------|
| Layout(Type) | 1LDK(A2-60W') | Area | 59.97㎡ (645.2772 sq. ft.) |
| Rent | ¥ 410,000 | Public maintenance fee Administration cost | included in rent |
| Deposit Key money | 2 Months · None | Renewal fee | None |
| Transaction type (Year) | Periodic Tenancy Contract (3 Years) | Status | Vacancy soon (Moving out: 02/2025) |
| Note | •This property is only for residential purposes, except the SOHO | | |
| Equipments | Please contact us if there is any question. | | |
| Completed | January,2010 | | |
| Constructing | · Steel construction, steel framed reinforced concrete structure, reinforced concrete construction · 44 stories | | |
| Location | 6-15-1 Nishi-Shinjuku, Shinjuku-ku, Tokyo | | |
| Trains | Nishi-Shinjuku Stn., Marunouchi Line (7-min. walk) Tochomae Stn., Oedo Line (5-min. walk) Shinjuku Stn., JR Line (13-min. walk) | | |
| |  | | |

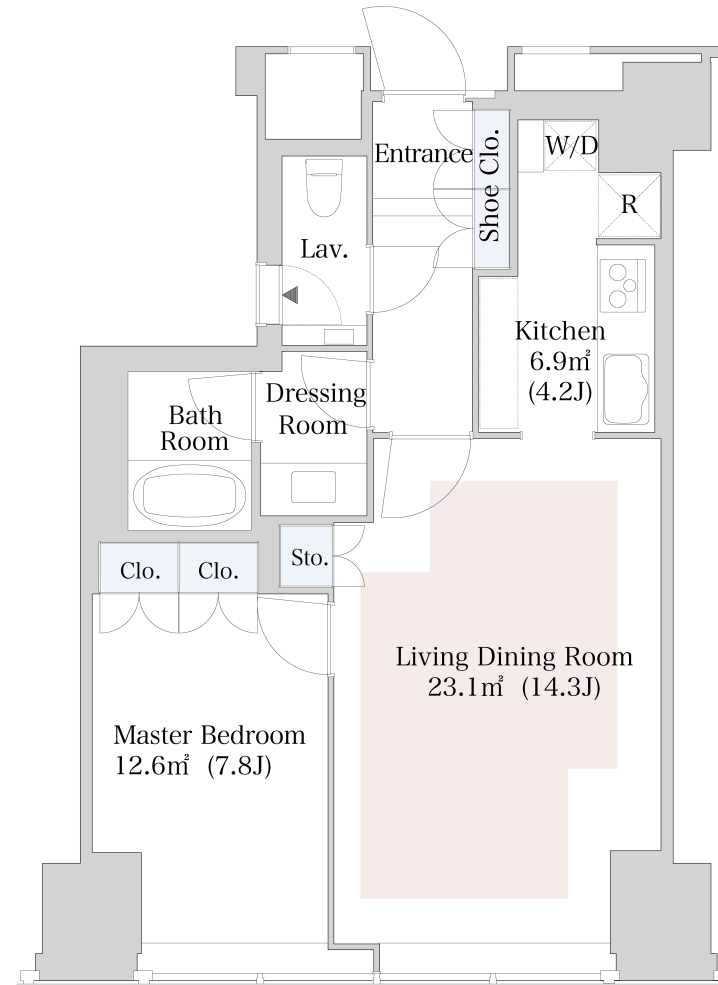

- Lease guarantee agreement: required (by a guarantee company designated by us)
Guarantee fee: 30% of lease for the first year, 8,000 yen/year for the second and subsequent years
Fees may vary depending on the guarantee company - contact us for more details.
- All rentals are on a first-come-first-served basis.
- Multi-risk home insurance is mandatory.
- Deposits equivalent to one month of rent are non-refundable at the end of the contract.
- If the contract is terminated in less than one year, a penalty equivalent to one-month rent will be applied.
- When disparities arise between the drawing and the actual construction, the actual construction takes precedence.

Sumitomo Realty & Development Co., Ltd.

Shinjuku NS Building, 2-4-1, Nishi-Shinjuku Shinjuku-ku, Tokyo 163-0820 Japan

Phone: +81-3-3346-9510

Phone: 0120-770-507

for Real estate company: +81-3-3346-9510

Please contact us if there is any question.