

# La Tour Shibuya Apartment No. 2008 (20F)

Update Date : 2024/11/23 Next scheduled update date: Anytime

Layout(Type)	1LDK(I)	Area	59.82㎡ (643.6632 sq. ft.)
Rent	¥ 530,000	Public maintenance fee Administration cost	included in rent
Deposit Key money	2 Months · None	Renewal fee	None
Transaction type (Year)	Periodic Tenancy Contract (3 Years)	Status	Vacancy soon (Moving out: 12/2024)
Note	25story high-rise apartments 8-min. walk to Shibuya Stn., 11-min. walk to Omote-sando Stn 24-hour Concierge 24-hour Security 1 month rent will be deducted at the time of move-out.  *This property is only for residential purposes, except the SOHO		
Equipments	Please contact us if there is any question.		
Completed	August,2010		
Constructing	· Reinforced concrete structure, partially steel frame structure, · steel frame reinforced concrete structure · anti-sway structure · 25 floors above ground, 3 floors below ground, 2 floors pent house		
Location	2-20 Higashi 1-chome, Shibuya-ku, Tokyo		
Trains	Shibuya Stn., JR Line (8-min. walk) Omote-sando Stn., Ginza/Chiyoda Lines (11-min. walk)		

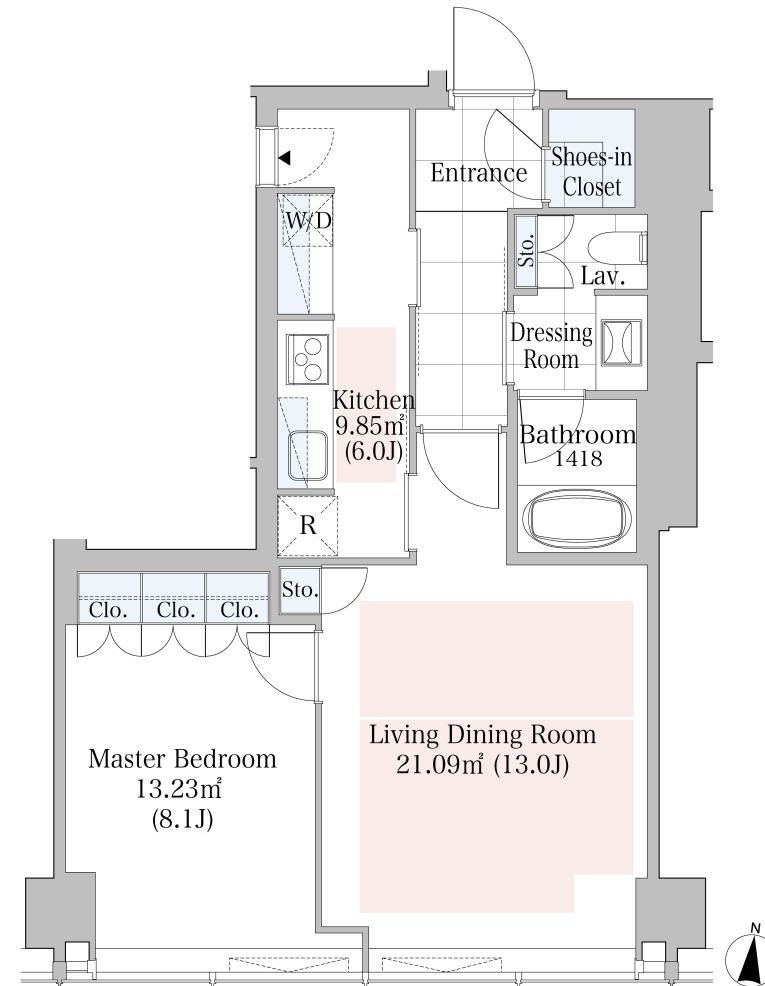

- Lease guarantee agreement: required (by a guarantee company designated by us)  
 Guarantee fee: 30% of lease for the first year, 8,000 yen/year for the second and subsequent years  
 Fees may vary depending on the guarantee company - contact us for more details.
- All rentals are on a first-come-first-served basis.
- Multi-risk home insurance is mandatory.
- Deposits equivalent to one month of rent are non-refundable at the end of the contract.
- If the contract is terminated in less than one year, a penalty equivalent to one-month rent will be applied.
- When disparities arise between the drawing and the actual construction, the actual construction takes precedence.

Sumitomo Realty & Development Co., Ltd.

Shinjuku NS Building, 2-4-1, Nishi-Shinjuku Shinjuku-ku, Tokyo 163-0820 Japan

Phone: +81-3-3346-9510

Phone: 0120-770-507

for Real estate company: +81-3-3346-9510

Please contact us if there is any question.