

La Tour Aobadai Apartment No. 3102 (31F)

Update Date : 2024/11/23 Next scheduled update date: Anytime

| | | | |
|----------------------------|-------------------------------------------------------------------------------------------------------------------------------------------------------------------------------------------------------------|-----------------------------------------------|-------------------------------------------|
| Layout(Type) | 1LDK(B) | Area | 56.17㎡ (604.3892 sq. ft.) |
| Rent | ¥ 490,000 | Public maintenance fee Administration cost | included in rent |
| Deposit Key money | 2 Months · None | Renewal fee | None |
| Transaction type (Year) | Periodic Tenancy Contract (3 Years) | Status | Move in possible now (After paperwork) |
| Note | Fitness lounge on 21nd floor Color Variation(White Chic/Stylish Brown) 1 month rent will be deducted at the time of move-out. •This property is only for residential purposes, except the SOHO | | |
| Equipments | Please contact us if there is any question. | | |
| Completed | August,2009 | | |
| Constructing | · Steel-frame, reinforced concrete · Anti-seismic res ponce control · 33 stories | | |
| Location | 3-6-28 Aobadai, Meguro-ku, Tokyo | | |
| Trains | Ikejiri-Ohasi Stn., Denentoshi Line (7- min. walk) Shinsen Stn., Inokashira Line (9-min. w alk) Shibuya Stn., JR Line (16-min. walk) | | |

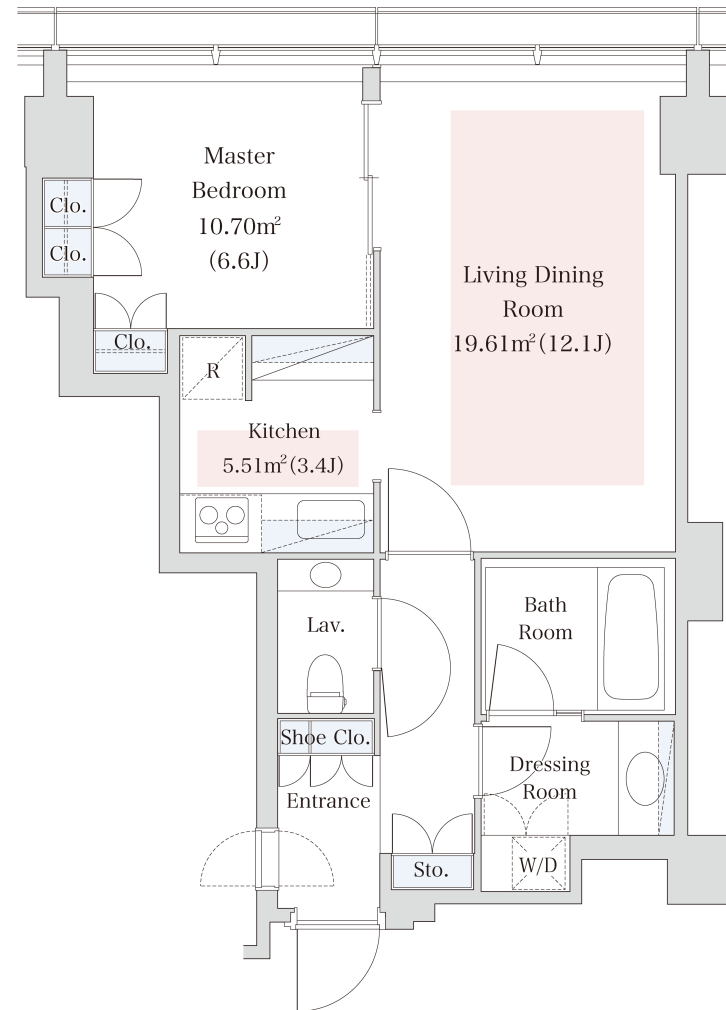

- Lease guarantee agreement: required (by a guarantee company designated by us)
 Guarantee fee: 30% of lease for the first year, 8,000 yen/year for the second and subsequent years
 Fees may vary depending on the guarantee company - contact us for more details.
- All rentals are on a first-come-first-served basis.
- Multi-risk home insurance is mandatory.
- Deposits equivalent to one month of rent are non-refundable at the end of the contract.
- If the contract is terminated in less than one year, a penalty equivalent to one-month rent will be applied.
- When disparities arise between the drawing and the actual construction, the actual construction takes precedence.

Sumitomo Realty & Development Co., Ltd.

Shinjuku NS Building, 2-4-1, Nishi-Shinjuku Shinjuku-ku, Tokyo 163-0820 Japan

Phone: +81-3-3346-9510

Phone: 0120-770-507

for Real estate company: +81-3-3346-9510

Please contact us if there is any question.