

La Tour Shinjuku Garden Apartment No. 3202 (32F)

Update Date : 2025/2/23 Next scheduled update date: Anytime

| | | | |
|----------------------------|--|---|---------------------------------------|
| Layout(Type) | 3LDK(U3-140S) | Area | 140.19㎡ (1508.4444 sq. ft.) |
| Rent | ¥ 1,020,000 | Public maintenance fee Administration cost | included in rent |
| Deposit Key money | 2 Months · None | Renewal fee | None |
| Transaction type (Year) | Periodic Tenancy Contract (3 Years) | Status | Vacancy soon (Moving out: 03/2025) |
| Note | <p>•This property is only for residential purposes, except the SOHO</p> | | |
| Equipments | Please contact us if there is any question. | | |
| Completed | March,2016 | | |
| Constructing | <p>・ RC, SRC, Steel-Frame ・ Anti-sway structure ・ 37 Stories</p> | | |
| Location | 3-8 Okubo, Shinjuku-ku, Tokyo | | |
| Trains | <p>Takadanobaba Stn., JR Line (7-min. walk) Takadanobaba Stn., Tozai Line (9-min. walk) Nishi-Waseda Stn., Fukutoshin Line (9-min. walk)</p> | | |

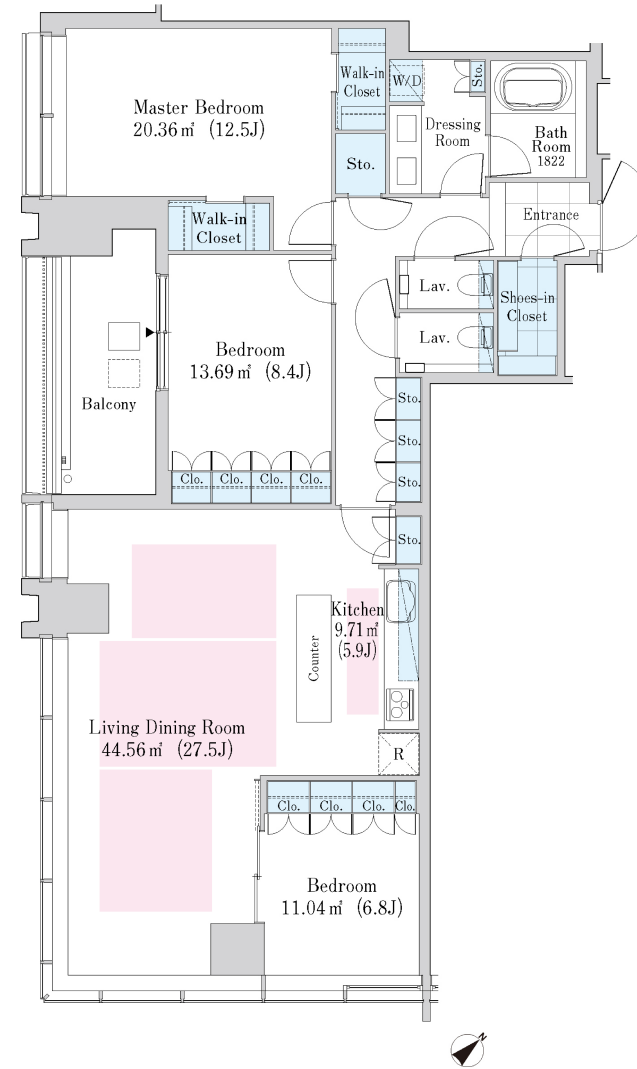

- 1 Lease guarantee agreement: required (by a guarantee company designated by us)
Guarantee fee: 30% of lease for the first year, 8,000 yen/year for the second and subsequent years
Fees may vary depending on the guarantee company - contact us for more details.
- 2 All rentals are on a first-come-first-served basis.
- 3 Multi-risk home insurance is mandatory.
- 4 Deposits equivalent to one month of rent are non-refundable at the end of the contract.
- 5 If the contract is terminated in less than one year, a penalty equivalent to one-month rent will be applied.
- 6 When disparities arise between the drawing and the actual construction, the actual construction takes precedence.

Sumitomo Realty & Development Co., Ltd.

Shinjuku NS Building, 2-4-1, Nishi-Shinjuku Shinjuku-ku, Tokyo 163-0820 Japan

Phone: +81-3-3346-9510

Phone: 0120-770-507

for Real estate company: +81-3-3346-9510

Please contact us if there is any question.