

# Bay-court Shibaura Apartment No. 211 (21F)

Update Date : 2024/11/23 Next scheduled update date: Anytime

|                            |  |   |   |
|----------------------------|--|---|---|
| Layout(Type)               | 3LDK(I-R1)   | Area  | 102.48㎡ (1102.6848 sq. ft.)               |
| Rent                       | ¥ 579,000  | Public maintenance fee<br>Administration cost | included in rent                          |
| Deposit<br>Key money       | 2 Months · None  | Renewal fee                                   | None                                      |
| Transaction type<br>(Year) | Periodic Tenancy Contract<br>(3 Years)   | Status  | Move in possible now<br>(After paperwork) |
| Note                       | 1 month rent will be deducted at the time of move-out.<br><br>•This property is only for residential purposes, except the SOHO |   |   |
| Equipments                 | Please contact us if there is any question.  |   |   |
| Completed                  | September, 1991  |   |   |
| Constructing               | · Steel-frame, reinforced concrete · 23 stories  |   |   |
| Location                   | 3-5-25 Shibaura, Minato-ku, Tokyo  |   |   |
| Trains                     | Mita Stn., Asakusa/Toei Mita Lines (7-min. walk)<br>Tamachi Stn., JR Line (6-min. walk)  |   |   |

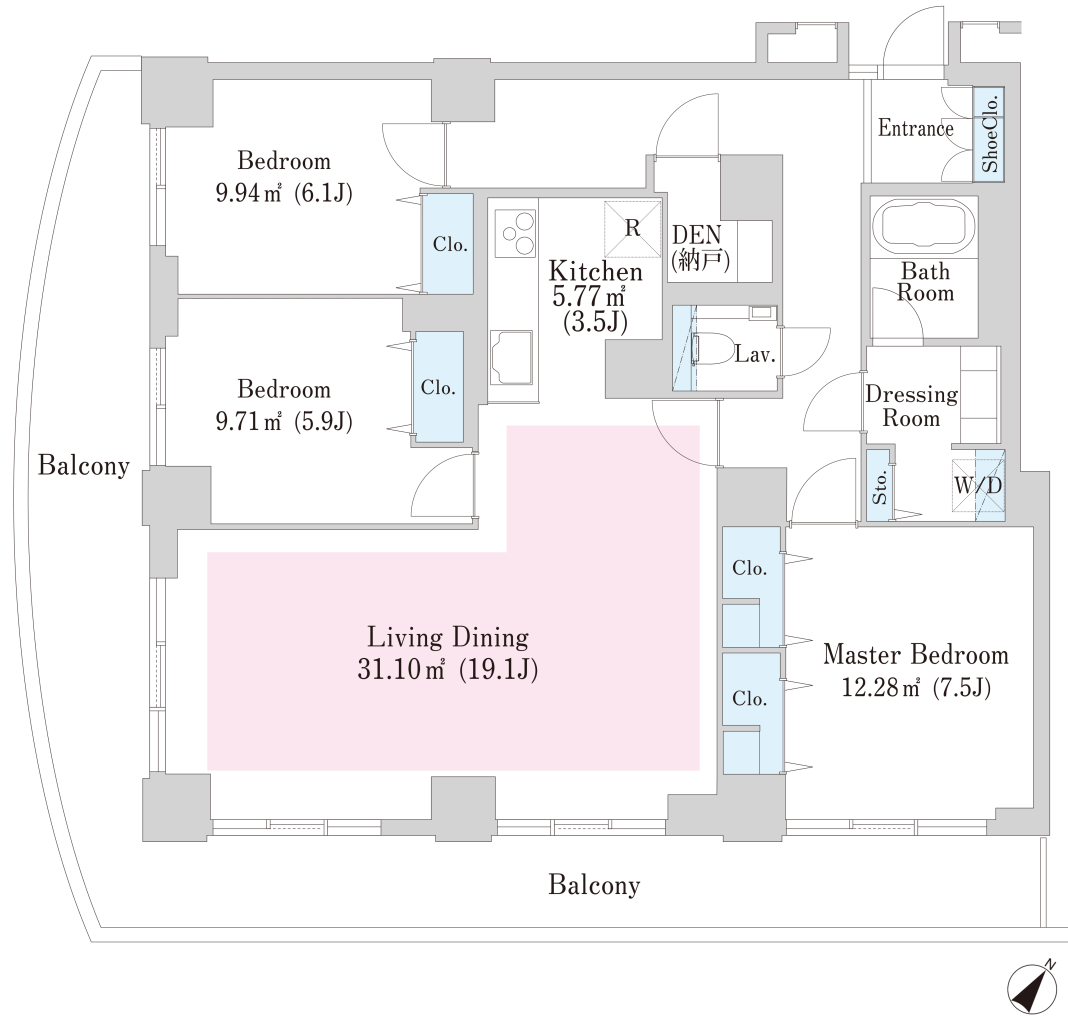

- Lease guarantee agreement: required (by a guarantee company designated by us)  
Guarantee fee: 30% of lease for the first year, 8,000 yen/year for the second and subsequent years  
Fees may vary depending on the guarantee company - contact us for more details.
- All rentals are on a first-come-first-served basis.
- Multi-risk home insurance is mandatory.
- Deposits equivalent to one month of rent are non-refundable at the end of the contract.
- If the contract is terminated in less than one year, a penalty equivalent to one-month rent will be applied.
- When disparities arise between the drawing and the actual construction, the actual construction takes precedence.

Sumitomo Realty & Development Co., Ltd.

Shinjuku NS Building, 2-4-1, Nishi-Shinjuku Shinjuku-ku, Tokyo 163-0820 Japan

Phone: +81-3-3346-9510

Phone: 0120-770-507

for Real estate company: +81-3-3346-9510

Please contact us if there is any question.